

## Commercial Space Available For Lease on Aldea Plaza

The Café on the Aldea Plaza could offer coffee shop style breakfasts, café style lunches, premiere evening dining, deli style take-out, specialty coffee drinks, wine & beer bar, teas and baked goods.

This café could soon evolve into a destination fine dining restaurant.

## Southwest with a Twist

Imagine a world fusion destination restaurant offering breathtaking mountain views and a premiere indoor/outdoor sunset dining experience. The menu could include a culinary exploration of international cross-cultural fusion style cuisine along with local delights that honor popular Santa Fe regional traditions.

## The Aldea Plaza

Aldea Plaza will likely become a popular west side destination of unique specialty shops, inviting cafés, intimate galleries, Live/Work Lofts, restaurants, grocery market, art studios and commercial offices.



**Commercial Space  
Available for Lease:  
505.995.0075**

### Location:

19 -17 Via Plaza Nueva  
Aldea de Santa Fe  
Santa Fe, New Mexico 87507

Phone: 505.995.0075  
Web: [www.LiveWork7478.com](http://www.LiveWork7478.com)  
Email: [design@CometStudios.com](mailto:design@CometStudios.com)



### The Café could also include:

- Upscale Grocery Market
- Music Venue and Outdoor Amphitheater featuring local musicians
- Outdoor Dining Terrace Garden
- Residential Unit

### Commercial Lease Available:

- Destination Café/Restaurant space available with support kitchen and catering possibilities
- Indoor seating capacity of 50 with expansion potential to 150 on the Plaza level
- Pueblo style building with the best sunset dining views in Santa Fe



**Commercial Café Space Available  
for Lease: 505.995.0075**

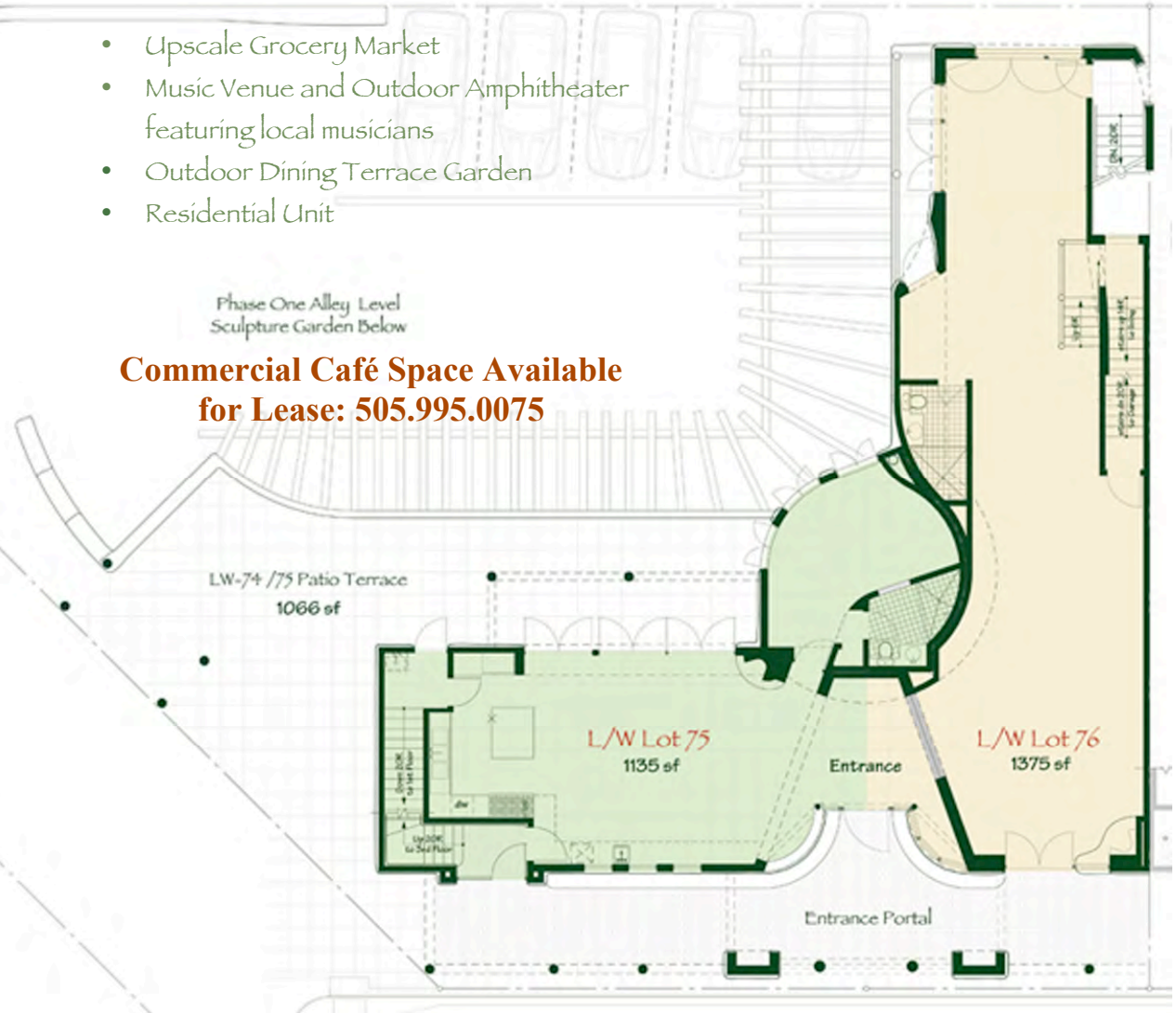

### Location:

19-17 Via Plaza Nueva  
Aldea Plaza  
Santa Fe, New Mexico 87507

Phone: 505.995.0075  
Web: [www.LiveWork7478.com](http://www.LiveWork7478.com)  
Email: [design@CometStudios.com](mailto:design@CometStudios.com)



**4,000 sf. Commercial Space  
Available for Lease to a  
Qualified Restaurant  
Entrepreneur  
505.995.0075**